

1<sup>st</sup> prize, Topic 2 Tertiary Category

## Verdant Village @ Changi

### **Team members:**

Tracy Tai                      Leong Yue Qi  
Eve Lee Shi                  Lim Qilei Daniel  
(National University of Singapore)

### **Participants' Write Up:**

Old Changi Hospital remains an iconic landmark in Singapore's history. Having served many people throughout its 86 years of operation, such as British soldiers, POWs and local citizens, its key identity has remained consistent: a place of healing and recovery.

The Verdant Village capitalises on this identity but shifts the focus from medicinal healthcare to nature and plants as key factors in promoting a lifestyle that prioritises mental and emotional well-being. This is done while maintaining and promoting the rich and unique heritage of Old Changi Hospital.

Several new functions are incorporated, such as a chalet, nature-inspired café, and treetop boardwalk. The 3 existing blocks would be refurbished and/or preserved to create a gradation of conservation that promotes this new lifestyle, while telling the story of Old Changi Hospital.

### **Jury Citation:**

The jury commended the proposal's intelligent use of terrain to create an interlaced boardwalk within the space, which would maximize the connectivity and utility of the site and provide new vantage points, while respecting the scale of the buildings of Old Changi Hospital. The introduction of chalet use to the building was also an interesting idea to create a lived-in dimension to an otherwise controversial building.

# VERDANT VILLAGE @ CHANGI

TOPIC 2: "REPURPOSING OF OLD CHANGI HOSPITAL"

OLD CHANGI HOSPITAL REMAINS AN ICONIC LANDMARK IN SINGAPORE'S HISTORY. HAVING SERVED MANY PEOPLE THROUGH ITS 86 YEARS OF OPERATION, SUCH AS BRITISH SOLDIERS, POWS AND LOCAL CITIZENS, IT'S KEY IDENTITY HAS REMAINED CONSISTENT: A PLACE OF HEALING AND RECOVERY.

THE VERDANT VILLAGE CAPITALISES ON THIS IDENTITY BUT SHIFTS THE FOCUS FROM MEDICINAL HEALTHCARE TO NATURE AND PLANTS AS KEY FACTORS IN PROMOTING A LIFESTYLE THAT PRIORITISES MENTAL AND EMOTIONAL WELL-BEING.

THIS IS DONE WHILE MAINTAINING AND PROMOTING THE RICH AND UNIQUE HERITAGE OF OLD CHANGI HOSPITAL. SEVERAL NEW FUNCTIONS ARE INCORPORATED, SUCH AS A CHALET, NATURE-INSPIRED CAFÉ AND TREETOP BOARDWALK.

THE 3 EXISTING BLOCKS WOULD BE REFURBISHED AND/OR PRESERVED TO CREATE A GRADATION OF CONSERVATION THAT PROMOTES THIS NEW LIFESTYLE, WHILE SHARING THE STORY OF OLD CHANGI HOSPITAL.



STITCHED GROUND  
PLAN 1:500

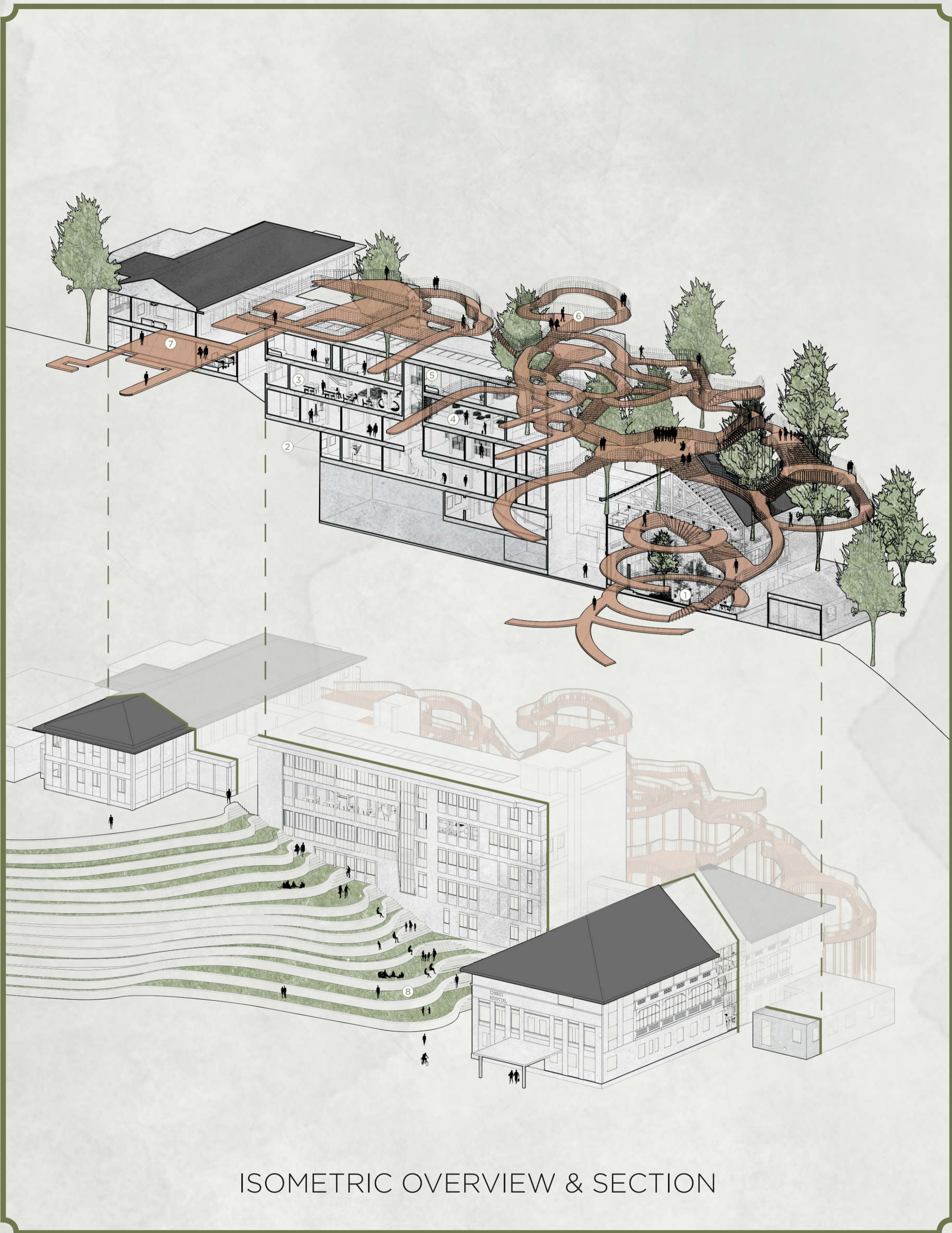

BLOCK 24 WILL BE TRANSFORMED EXTENSIVELY INTO A LARGE CAFÉ WITH POCKETS OF GREENERY AND INTIMATE DINING AREAS THAT RESULT FROM THE PRESERVATION OF OLD WALLS AS PARTITIONS.

AN EXHIBITION SPACE FOR VARIOUS EVENTS OCCUPY THE LOWER FLOORS OF BLOCK 161, AND CHALET ROOMS WITH COMMUNAL LIVING SPACES AND URBAN GARDENS WOULD BE SITUATED IN THE UPPER FLOORS.

THE UNIQUE CHARACTER OF BLOCK 37 WILL BE RETAINED THROUGH THE PRESERVATION OF ITS CURRENT DILAPIDATED STATE. THIS WILL PROVIDE A BACKDROP FOR HERITAGE TRAILS AND URBAN EXPLORATION, WITH EXISTING ROOMS AS DEDICATED SPACES FOR THE PUBLIC TO LEARN ABOUT OLD CHANGI HOSPITAL AND ITS ROLE IN SINGAPORE'S HISTORY.

PROGRAMMES:

- ① CAFE
- ② EXHIBITION SPACES
- ③ COMMUNAL SPACES
- ④ URBAN GARDENS
- ⑤ CHALET ROOMS
- ⑥ URBAN EXPLORATION BOARDWALK
- ⑦ HERITAGE EXHIBITION SPACES
- ⑧ EVENT SPACE

ILLUSTRATIONS / RENDERS:

- A EVENT SPACE
- B CHALET
- C CAFE
- D URBAN EXPLORATION BOARDWALK

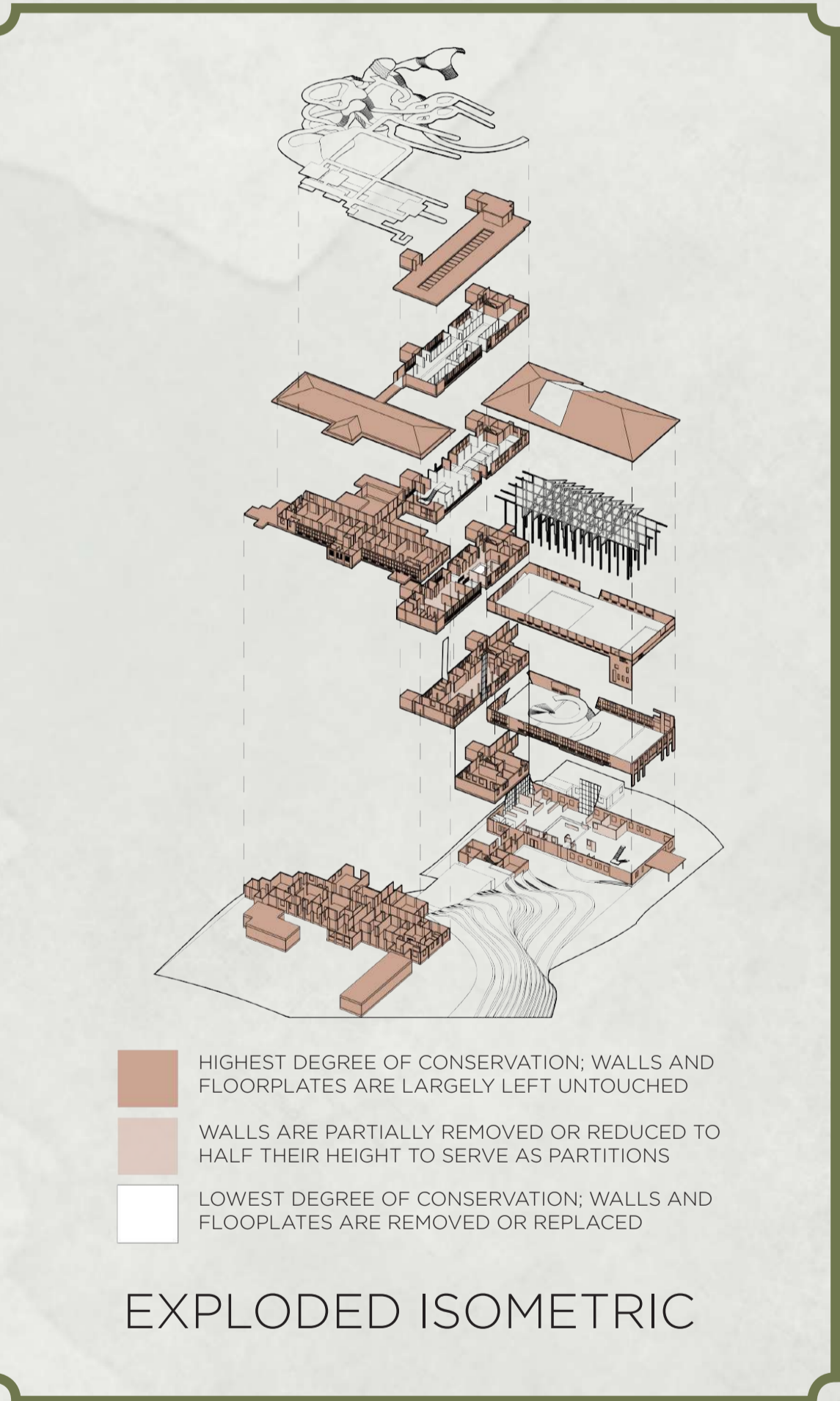

- HIGHEST DEGREE OF CONSERVATION: WALLS AND FLOORPLATES ARE LARGELY LEFT UNTOUCHED
- WALLS ARE PARTIALLY REMOVED OR REDUCED TO HALF THEIR HEIGHT TO SERVE AS PARTITIONS
- LOWEST DEGREE OF CONSERVATION: WALLS AND FLOORPLATES ARE REMOVED OR REPLACED

EXPLODED ISOMETRIC

IN ADDITION TO THE EXISTING BLOCKS, A BOARDWALK EXTENDS THROUGHOUT THE PREMISE, BEING THE MAIN MEANS OF CIRCULATION WHILE CURATING VIEWS OF THE FOREST BEHIND IT. THE LAST ADDITIONS ARE THE WOODEN BERMS AND PLATFORMS THAT SIT ON THE SIDE OF THE HILL, AND SERVE TO TIE THE INDIVIDUAL BUILDINGS AND PROGRAMS TOGETHER AS A CENTRAL OUTDOOR EVENT SPACE.

VERDANT VILLAGE @ CHANGI



EVENT SPACE

A FLEXIBLE SPACE THAT CATERS FOR LARGE GATHERINGS AND FESTIVALS THE ENTIRE SPACE FACES THE ICONIC CHANGI HOSPITAL FAÇADE WITH TERRACED PLATFORMS FOR REST AND PLAY. AT NIGHT, SOFT LIGHTING AND A DEDICATED STAGE CREATE A SETTING SUITABLY BEFITTING VARIOUS PERFORMANCES SUCH AS ARTS SHOWCASES AND MOVIE SCREENINGS.



CHALET

LOCATED AT THE HIGHER FLOORS OF BLOCK 161, THE CHALET TAKES ON A CO-LIVING CONCEPT WITH COMMUNAL SPACES FOR ITS RESIDENTS. URBAN GARDENS ARE ADOPTED TO PROMOTE SUSTAINABLE LIVING AND RELAXATION. A CENTRAL COURTYARD ENCOURAGES INTERACTION BETWEEN RESIDENTS WHETHER THEY ARE IN THE LIVING QUARTERS OR COMMUNAL SPACES.



GARDEN-THEMED CAFE

SITTING AT THE MAIN ENTRANCE, THE CAFÉ IS THE PUBLIC'S FIRST ENCOUNTER OF THE REFURBISHED CHANGI HOSPITAL BUILDING, AND THEREFORE SETS THE TONE OF THE ENTIRE FACILITY. ATRIUMS ARE PUNCTURED THROUGH THE FLOORPLATES, SO AS TO OPEN EACH FLOOR TO THE INDOORS GARDEN FEATURING THE BOARDWALK THAT SPIRALS UP AND AROUND THE ATRIUM. THIS IN HOPES OF EXPRESSING THE FANTASTICAL BEAUTY OF NATURE AND HEALING, AMIDST THE PARTIALLY PRESERVED RUINS OF THE PREVIOUS BUILDING.



URBAN EXPLORATION BOARDWALK

AS THE SITE IS SURROUNDED IN NATURE, A BOARDWALK IS PROPOSED TO NOT ONLY IMMERSE VISITORS IN NATURE, BUT ALSO TO IMPROVE CONNECTIVITY BETWEEN THE BLOCKS. THE BOARDWALK TRAVERSES THROUGH BLOCK 37 AS WELL, OCCASIONALLY OPENING UP TO LARGER PLATFORMS WHERE PROJECTIONS CAN BE SCREENED. THE ORGANIC NATURE OF THE BOARDWALK AIMS TO CAUSE MINIMAL DISRUPTION TO EXISTING TREES. ALONG THE BOARDWALK, VISITORS MAY ALSO LEARN MORE ABOUT THE HISTORY OF OLD CHANGI HOSPITAL AND THE FLORA AND FAUNA.