

1st prize, Topic 1 Open Category

Changi Point: Nature & Nurturing

Team members:

April Valle

Artlheene Rivera

Participants' Write Up:

Changi Point is positioned as a Creative and Gastronomic Hub set within thriving rainforest and coastal landscapes. Following principles of regenerative development, the proposal shows how the rainforest, coastal landscapes and biodiversity at Changi Point could be enhanced with vegetation cover and more sustainable infrastructure and design. Proposed developments are respectful of Changi Point's context, highlighting its rich built environment heritage and recreational spaces along the coast. The wide variety of uses aims to attract a diversity of visitors to new community spaces, which not only establish Changi Point as a destination, but also complement Singapore's network of trails and green spaces. They also promote the health and well-being of the community and ecosystems, and draw links to Singapore's Sustainable Development Goals.

Jury Citation:

The jury commended this submission for its combination of proposals that magnified the unique aspects of Changi Point while impressively addressing the complexity of the site. The proposals were sensitive to the scale, terrain and historical background of the area, with an overarching unifying theme of nature and sustainable development that was apt and inspiring. In particular, the forest trail stood out as a thoughtful addition to the area. The variety of proposed uses worked well with each other and would resonate with many people.

Concept Master Plan
for Changi Point

CHANGI POINT: NATURE & NURTURING

1. CHANGI BEACH CLUB PARK

The park will be transformed with a design that is more suited to its seaside setting – a more **organic form** with its open layout and expressive use of natural materials. **Coastal vegetation** will be used for landscaping. This space functions as a gathering and rest area along the Coastal Walk, with its expanded lounging area and **breathtaking views** of Pulau Ubin and the sunset.

BETTER COASTAL CONNECTIONS

2. CHANGI OPEN FIELD BEACH PARK

The Open Field will include three diverse areas: a wider **beach deck** along the Coastal Walk, a **multi-purpose field**, and an **off-leash dog park**. It is a place for rest and recreation for individuals and groups, and for dogs and their humans.

Its flexible uses and **unique outdoor seaside setting** are the space's special quality for activities and holding events like moonlight cinemas, group fitness classes or outdoor concerts.

DESTINATION CREATION

3. CHANGI FOREST TRAIL

Bird watching, meditation and **forest bathing** are some of the activities that can be done at the Forest Trail. The trail will be restored with **indigenous planting** to rehabilitate its lush and wild landscape. This forms part of the Dark Zone, where low level lighting or darkness is encouraged to minimise disturbance to wildlife living in the vicinity.

REWILDING THE CITY



4. COMMUNITY GARDENS

Located on vacant plots near the more private residences, community gardens provide a space for neighbours to **interact with each other** and to **grow fresh, nutritious food** close to their homes.

REGENERATIVE COMMUNITY SPACES

5. CHANGI POINT PAVILION

This **temporary pavilion** is intended to be **redesigned annually by a different architect**. With a matching **Cultural Programme**, it is a new cultural attraction within Changi Point. When not in use, it serves as a Teahouse, and an elegant shelter at the start of the Forest Trail at Turnhouse Park.

AIMING FOR EXCELLENCE

6. TURNHOUSE PARK

The park will have an improved outdoor gym for seniors and children, adequate **public seating**, all-access public toilets and artistic water features promoting nature play. It connects to the Old Changi Hospital Precinct with direct access through the Skybridge.

ENRICHING EXPERIENCES

7. CHANGI SUNSET WALK

The western terminus of the Coastal Walk will be enhanced with **spacious seating**, **informational signage** and **public art**, for more comfort when admiring the dramatic sunset views from this section.

DESTINATION CREATION

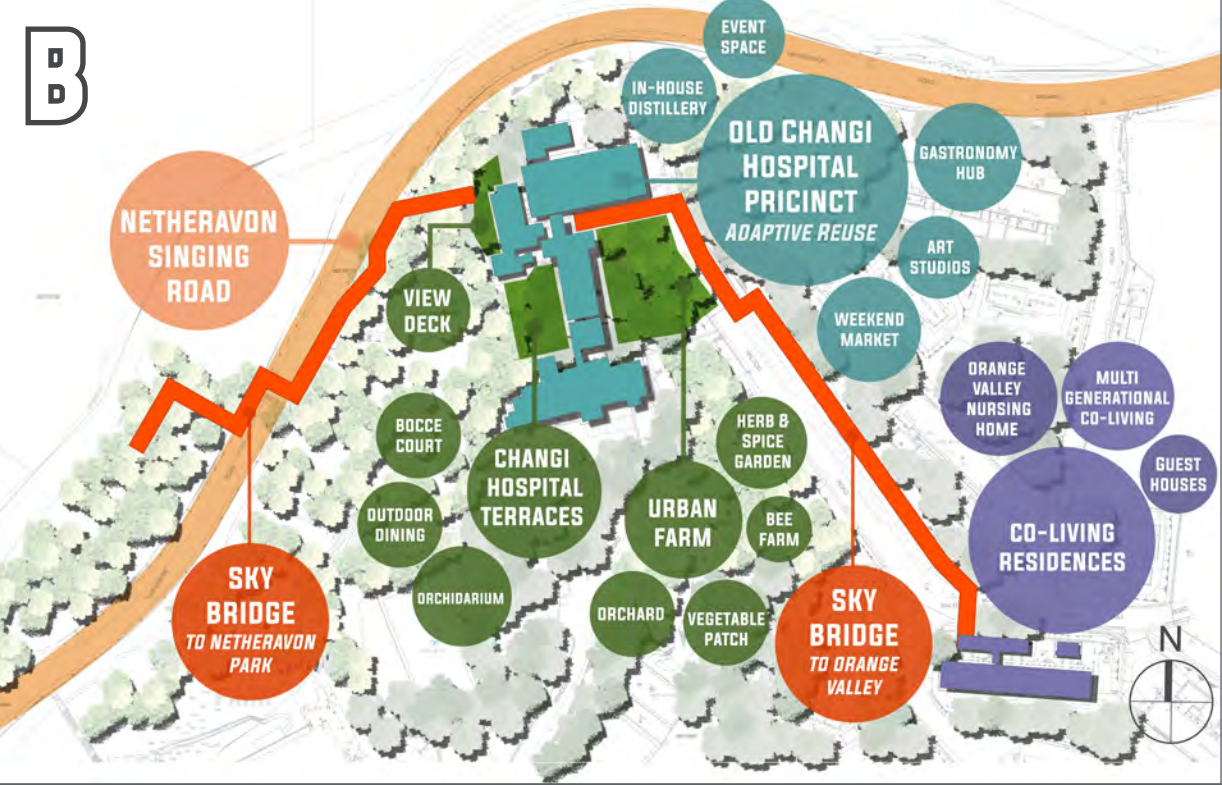

8. OLD CHANGI HOSPITAL PRECINCT

The Old Changi Hospital site will be positioned as a future **Creative and Gastronomy Precinct**, highlighting **Singaporean culture and talent**, with creatives taking inspiration from Changi Point's wild natural landscapes and rich heritage.

The precinct will accommodate the following creative workspaces to support this: **gastronomic atelier**, **in-house distillery**, **urban farm**, **bee farm**, **recording and practice studios**, **fabrication labs**, and other co-creation spaces. This creative energy will be showcased in **galleries**, **event spaces** and **casual and fine dining restaurants** located in beautiful indoor and outdoor settings.

The activity mix enables low-impact activities and maintains a steady volume of users on-site throughout the week to support its success as an economic hub.

PROTECT THE CHARM

9. NETHERAVON SINGING ROAD

To iconise this section of the Loyang Park Connector, as well as a **traffic-calming intervention**, Netheravon Road will be transformed into a **'musical road'**. Vibrations from wheels passing at the road's prescribed speed limit will correctly **'sing' a martial tune**, in reference to Changi Point's well-known military history.

EXPLORING CREATIVE INTERVENTIONS



11. CHANGI INCUBATOR HUB

Similar uses and tenants to the BNP Paribas Centre will be recommended for its adjacent buildings, forming an Incubator Hub to complement the Old Changi Hospital Precinct, but catering to **Design, Tech and Innovation** industry activities which require more private quarters.

SUPPORTING CROSS-INDUSTRY POLLINATION

12. FAIRY POINT VILLAS

The **Civil Service Club Villas** will be **retained**, continuing with its objectives of honouring civil service officers. Each unit will be redesigned by a different local designer, eventually forming a 'design park' featuring **Singaporean designers** and local craftsmanship.

A PLACE FOR THE PEOPLE

13. CHANGI POINT RESIDENCES

Several units will be leased out as affordable housing for **retirees** and **creatives** employed at the Creative Precinct, to promote a **multi-generational co-living experience** that provides ease of access to natural environments and community spaces that inspire creativity and promote well-being.

MULTI-GENERATIONAL CO-LIVING

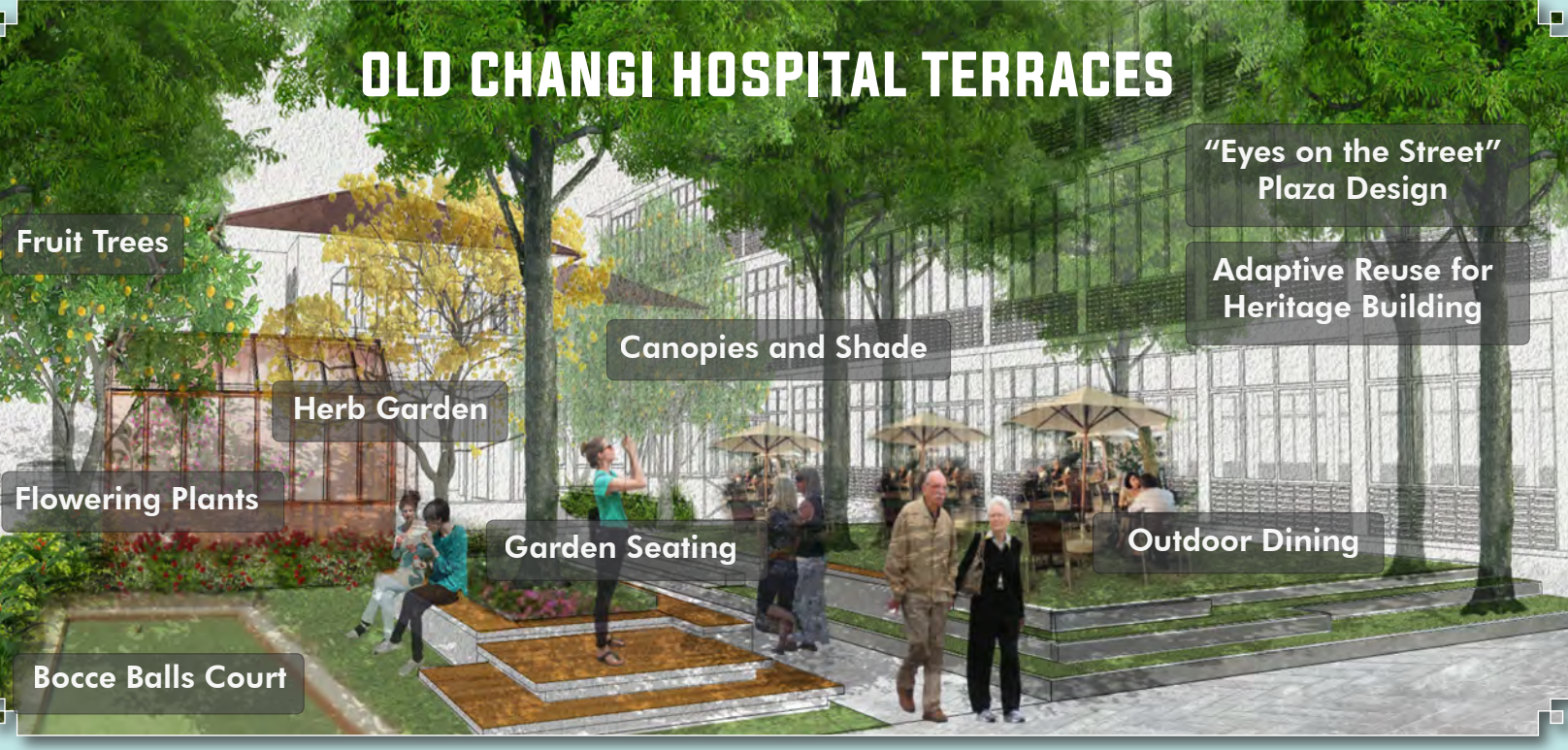

10. CHANGI POINT SKY BRIDGE

This **elevated tree-top walkway** provides an improved nature-immersed pedestrian link between the Old Changi Hospital Precinct, Turnhouse Park and the Nursing Homes on Halton Road. It provides the perfect spot for 'listening' to Netheravon Road when it is 'singing' and a strategically located platform from where one can peek into the activities of the studios inside the Old Changi Hospital studios.

COMMUNING WITH NATURE

A PLACE TO THRIVE, CREATE AND COMMUNE, SET WITHIN ABUNDANT NATURE AND UNIQUE HERITAGE

CHANGI POINT: NATURE & NURTURING

Concept Master Plan
for Changi Point

DEVELOPMENT FRAMEWORK

The diagram below illustrates the framework which guided the development of the conceptual masterplan. It proposes to position Changi Point as a **Creative and Gastronomic Hub** set within **thriving rainforest and coastal landscapes**. Future development celebrates its existing heritage buildings and seeks to revive the area's lush natural vegetation, while creating more spaces for the community at the same time.

Further, the plan aims to attract diverse users for the site by enabling activities that encourage **collaboration** and **community-building** that highlight and nurture Singaporean talent through shared hobbies, interests and needs. In summary, the plan follows a **Regenerative Development** strategy to showcase the area's best qualities while promoting the health and well-being of its community and ecosystems.

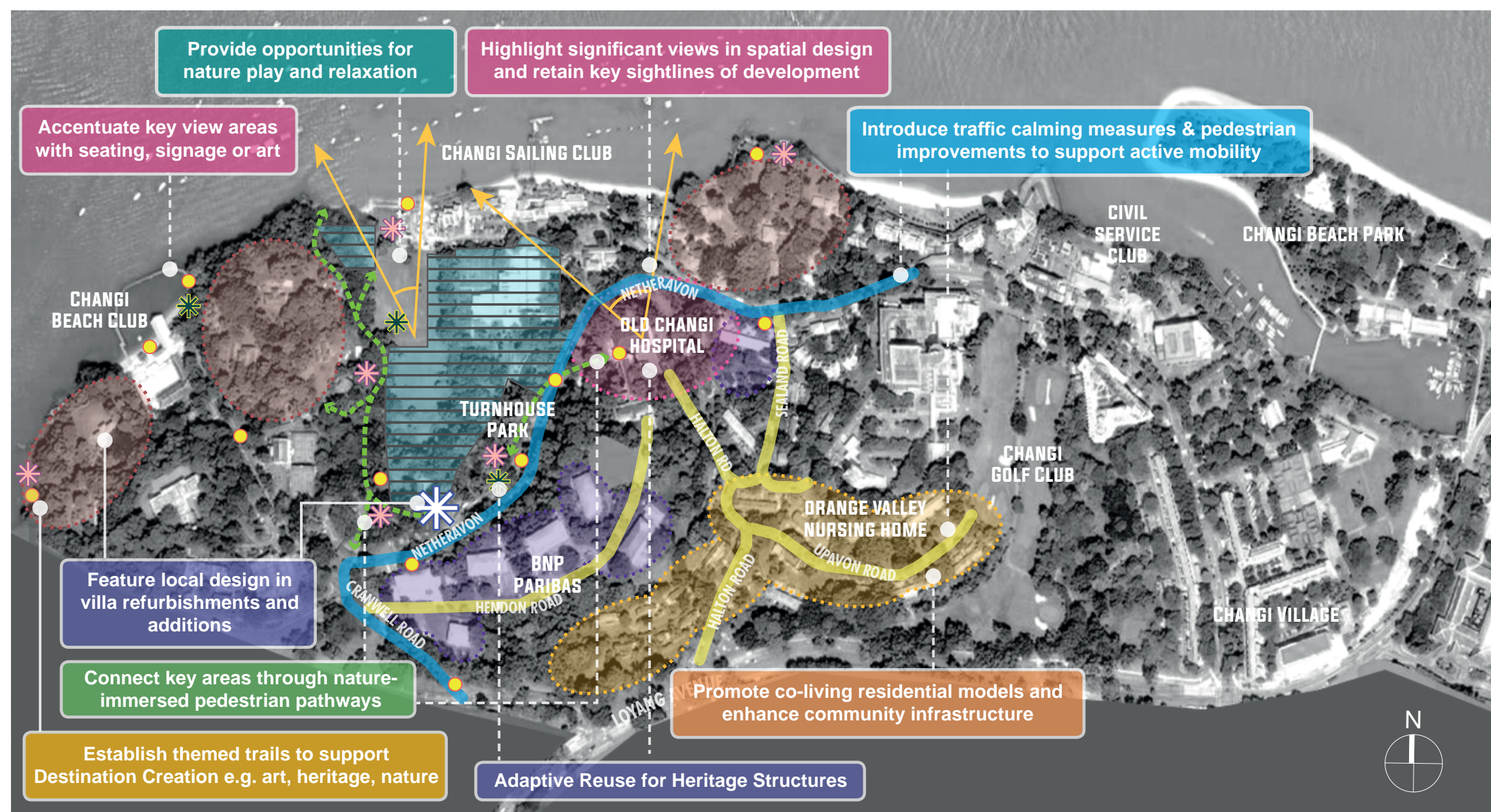

- CREATIVE AND GASTRONOMY PRECINCT
- CO-LIVING PRECINCT
- COMMERCIAL / INSTITUTIONAL PRECINCT
- FUTURE SPORTS & RECREATION FACILITY
- REDESIGNED VILLAS
- ARCHITECTURE PAVILION / TEAHOUSE
- MAINTAIN CLEAR SIGHTLINES IN SIGNIFICANT VIEW CORRIDORS / VIEW POINTS
- NATURE-IMMERSED PATHWAYS
- PEDESTRIAN-FOCUSED ROAD IMPROVEMENTS
- ENHANCE USING SHARED ROAD PRINCIPLES
- POINT OF INTEREST FOR WALKING TRAILS
- SEATING OR REST AREA
- NATURE PLAY AREA

GREEN STRATEGY

This concept aims to implement strategies identified by the **Singapore Green Plan 2030**. It seeks to revive Changi Point's original rainforest and coastal landscapes through improvement of vegetation cover, enhancement of biodiversity through rewilding its landscape with native vegetation, and promotion of habits that support sustainable living.

Adaptive reuse is widely promoted for existing buildings, to minimise further excavation and construction works. Several 'corrections' are also prescribed, wherein it is recommended to replace hard-engineered or overly 'urban' structures with structures inspired by biophilic design, particularly when these are located in natural settings. Detailed actions are prescribed below.

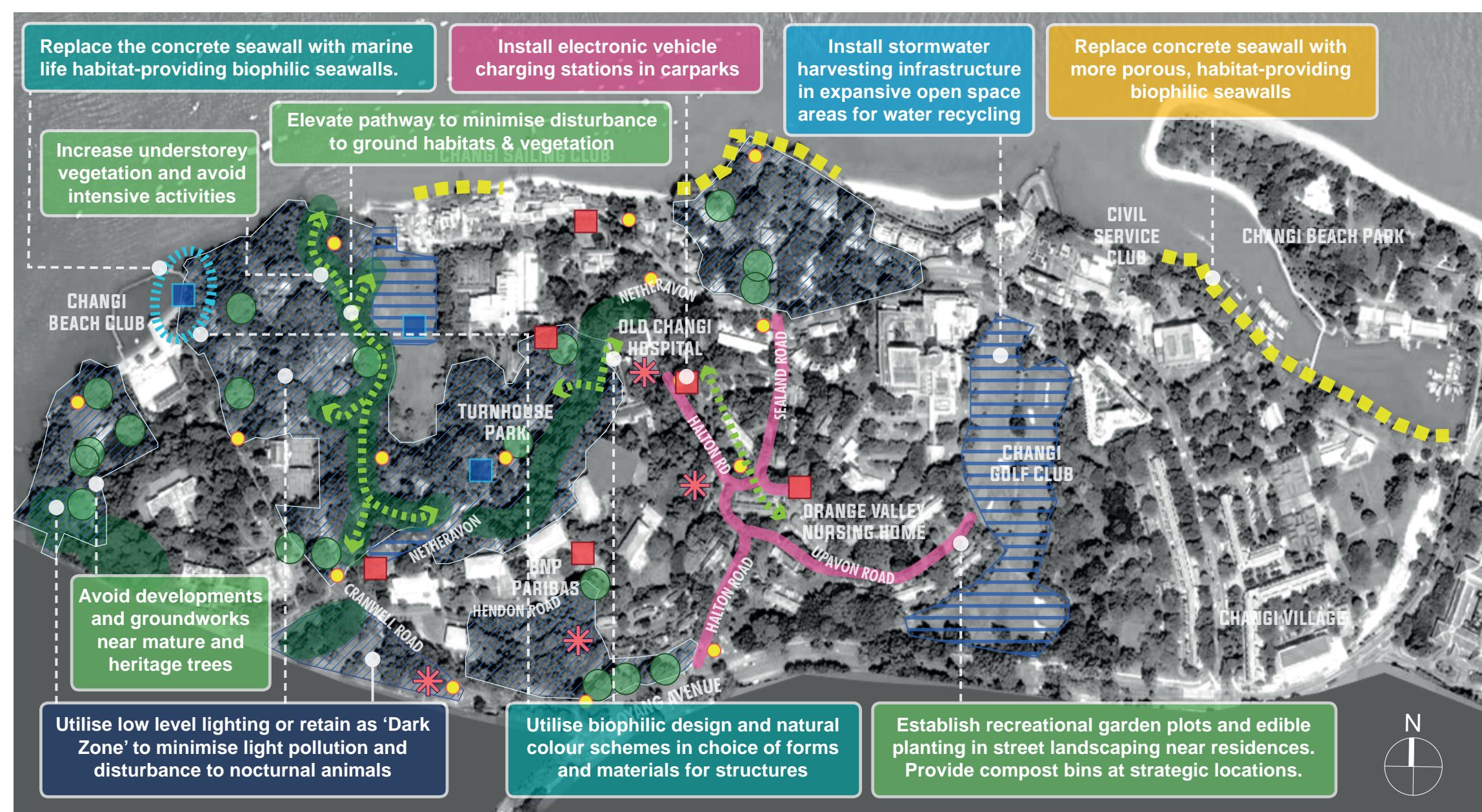

- ENHANCED STREETSIDE PLANTING W/ HERBS & FRUIT TREES
- INCREASE UNDERSTOREY VEGETATION & FOREST CANOPY
- ELEVATED PATHWAY
- BIOPHILIC SEAWALL
- DARK ZONE OR LOW LEVEL LIGHTING
- COMMUNITY GARDEN PLOTS NEAR RESIDENTIAL AREAS
- STORMWATER HARVESTING
- MAINTAIN GROUND PERMEABILITY ABOVE THE CRITICAL ROOT ZONE OF HERITAGE & MATURE TREES
- INCORPORATE ANIMAL HABITATS INTO STREET FURNITURE ALONG TRAILS E.G. BEE HIVES, INSECT HOTELS, BIRD HOUSES
- WATER FEATURES FOR COOLING AND RECREATION
- REDESIGN STRUCTURE TO FIT IN W/ NATURAL LANDSCAPE BETTER
- ELECTRONIC VEHICLE CHARGING STATIONS

WHAT'S THE VISION FOR CHANGI POINT?



WHICH SUSTAINABLE DEVELOPMENT GOALS DOES THE PLAN CONTRIBUTE TO?

SDG 3: GOOD HEALTH & WELL-BEING	1 2 3 4 5 6 7 8 9 10
SDG 4: QUALITY EDUCATION	1 2 3 4 5 6 7 8 9 10
SDG 8: DECENT WORK AND ECONOMIC GROWTH	1 2 3 4 5 6 7 8 9 10
SDG 9: INDUSTRY, INNOVATION & INFRASTRUCTURE	1 2 3 4 5 6 7 8 9 10
SDG 12: RESPONSIBLE CONSUMPTION & PRODUCTION	1 2 3 4 5 6 7 8 9 10
SDG 13: CLIMATE ACTION	1 2 3 4 5 6 7 8 9 10
SDG 14: LIFE BELOW WATER	1 2 3 4 5 6 7 8 9 10
SDG 15: LIFE ON LAND	1 2 3 4 5 6 7 8 9 10
SDG 17: PARTNERSHIPS FOR THE GOALS	1 2 3 4 5 6 7 8 9 10

DIGITAL STORY TELLING

Hailed as one of the top Smart Cities in the world, it is necessary to consider digital engagement methods when implementing development strategies in Singapore.

The following augmented reality (AR) digital concepts are suggested to support the implementation of the physical developments proposed to generate interest and stimulate activities when establishing the narrative for Changi Point's existing and future attractions.

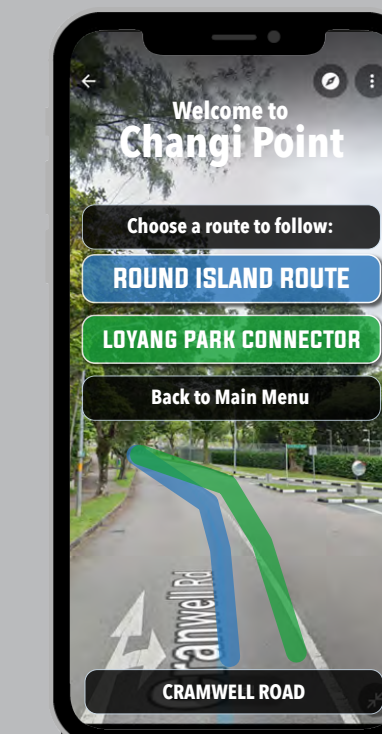

A. AR ROUTE FINDER

Presented in a 'Choose Your Own Adventure' format, this feature could employ the use of augmented reality to visualise existing trails (if any) located at the user's location and to offer an option for the user to turn on navigation for these routes.

It could also be integrated with fitness applications to support distance/time tracking, calorie counting, an option to design-your-own walking route and timer features.

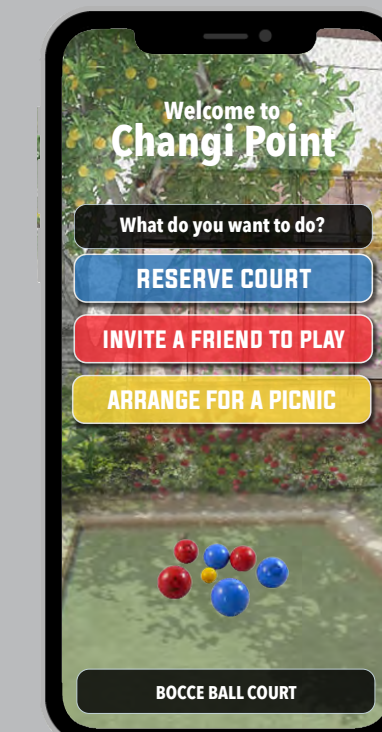

B. AR GAMES AND SERVICES

When used at community spaces, animations can appear at specific locations and/or conditions alongside a window of service options related to the location or item. In the example to the left, an animation of boules equipment appears with options to book the court, invite a friend and to order a picnic service.

Similarly, this could also be used to create a Digital Art Trail, an easter egg hunt style game where users can 'collect' art pieces from various locations.

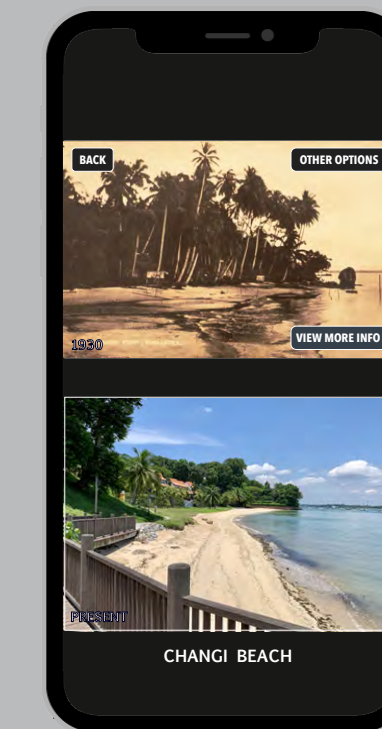

C. AR HISTORICAL TIMELINE CAMERA FILTER

Using camera filters, users can turn on filters that correspond to time periods, enabling them to view how the location from the real-life image on camera would have looked like from the certain period selected on the application.

Another option would be to enable a split-window view to show the actual view in comparison with the filtered view.

